

总高度 70mm  
Height of 70mm

YP - 50 - 70 - 20

安装面为 50mm  
Install panel is 50 mm

对刀面为 20mm  
The tool surface is 20mm

## 对刀回路 Tool setting loop

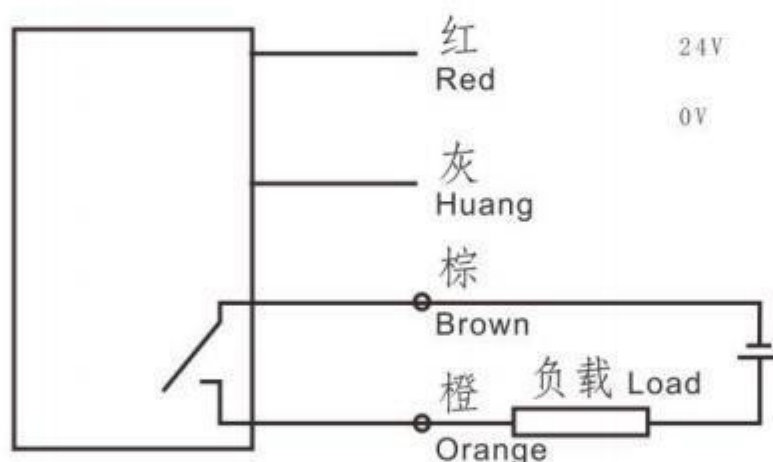

对刀信号OUT (对刀信号常时开, LED灯在输出信号时亮)  
The tool signal OUT (tool setting signal often open, LED lights when it output signal)

对刀信号源IN (回路需加负载, 限电流小于20MA, 推荐10MA)  
The tool signal source IN (loop needs to load, limiting current less than 20MA, recommending 10MA)

## 超程保护 Overtravel protection

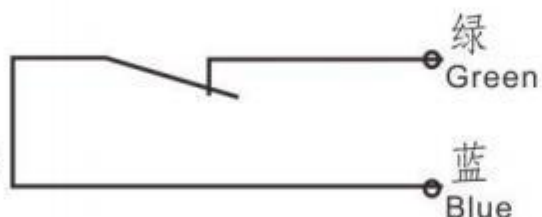

超程信号内定为常闭. (回路需加负载, 限电流小于20MA)  
Z轴过行程信号  
Distance signal is normally closed, (loop needs to load, limiting current less than 20MA) Z axis stroke signal.

- 注:
- 1 对刀底座提供38mm\*48mm (佳铁尺寸) 和两孔距40mm两种底座。
  - 2 吹气提供口径4MM和5MM两种
  - 3 触点额定值DC24V 20MA (推荐10MA) 电阻负荷。
  - 4 对刀速度50-200MM/MIN

Note: 1. The tool base provides two bases, one is 38mm\*48mm (JIA TIE size) and the other is 40mm between two hole.  
2. Providing blow caliber with 4MM and 5MM.  
3. Contact rating DC24V 20MA (recommended 10MA) resistive load  
4. The tool speed 50-200MM/MIN

- 注:
- 1 要校平上面对刀合金块 (重要)
  - 2 每次对好刀, 请用东西盖住,
  - 3 对刀平面重复定为精度0.001MM
  - 4 行程开关日本欧姆龙, 防水设计, 核心采用美德龙高精型号T24E的同类配件
  - 5 接线完毕, 接线完毕, 先放在安装对刀座的另外地方, 试了对刀信号正常后在安装正确的位置

Note: 1. Must level the tool alloy block (important)  
2. Every time after making good tool setting, please cover it with something.  
3. The tool plane repeat as the precision of 0.001MM.  
4. Travel switch by OMRON of Japan, the waterproof design and the core by METROL's high precision T24E similar parts.  
5. After wiring, putting in some place first at the installed tool base, after trying the normal tool signal, then installing in the correct position.

# YP 对刀仪

# YP tool checking instrument

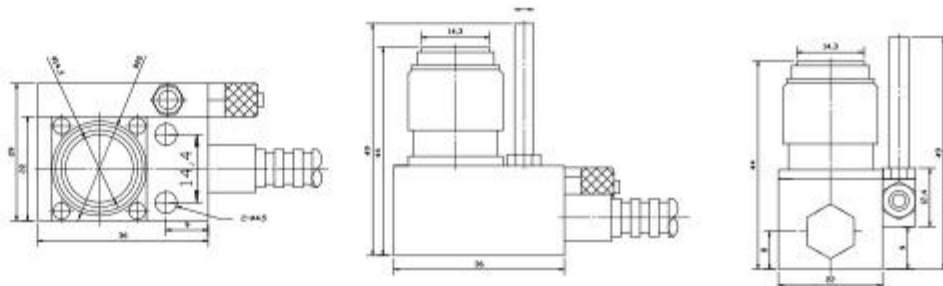

总高度为 44mm  
Height of 44mm

YP - 36\*29 - 44 - 14

安装面板为 36mm\*29mm  
Install panel is 36 mm \* 29 mm

对刀面为 14mm  
The tool surface is 14mm

## 对刀回路

Tool setting loop

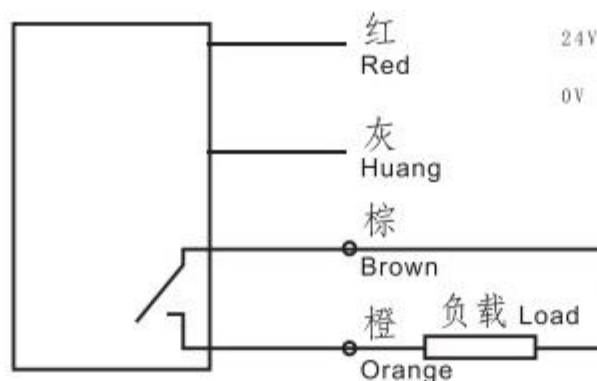

对刀信号OUT (对刀信号常时开, LED灯在输出信号时亮)  
The tool signal OUT (tool setting signal often open, LED lights when it output signal)

对刀信号源IN (回路需加负载, 限电流小于20MA, 推荐10MA)  
The tool signal source IN (loop needs to load, limiting current less than 20MA, recommending 10MA)

## 超程保护

Overtravel protection

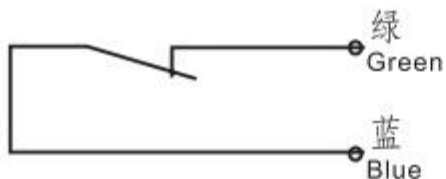

超程信号内定为常闭, (回路需加负载, 限电流小于20MA)  
Z轴过行程信号  
Distance signal is normally closed, (loop needs to load, limiting current less than 20MA) Z axis stroke signal.

- 注: 1 对刀底座提供38mm\*48mm (佳铁尺寸) 和两孔距40mm两种底座。  
2 吹气提供口径4MM和5MM两种  
3 触点额定值DC24V 20MA (推荐10MA) 电阻负荷。  
4 对刀速度50-200MM/MIN

- 注: 1 要校平上面对刀合金块(重要)  
2 每次对好刀, 请用东西盖住。  
3 对刀平面重复定为精度0.001MM  
4 行程开关日本欧姆龙, 防水设计, 核心采用美德龙高精型号T24E的同类配件  
5 接线完毕, 接线完毕, 先放在安装对刀座的另外地方, 试了对刀信号正常后在安装正确的位置

Note : 1. The tool base provides two bases, one is 38mm\*48mm (JIA TIE size) and the other is 40mm between two hole.  
2. Providing blow caliber with 4MM and 5MM.  
3. Contact rating DC24V 20MA (recommended 10MA) resistive load  
4. The tool speed 50-200MM/MIN

Note : 1. Must level the tool alloy block (important)  
2. Every time after making good tool setting, please cover it with something.  
3. The tool plane repeat as the precision of 0.001MM.  
4. Travel switch by OMRON of Japan, the waterproof design and the core by METROL's high precision T24E similar parts.  
5. After wiring, putting in some place first at the installed tool base, after trying the normal tool signal, then installing in the correct position.